

USE FOR VERTICAL, HORIZONTAL AND BOUNDARY CONTROL

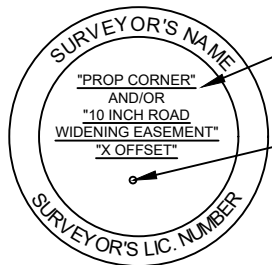

IDENTIFY ON BRASS DISC THE SPECIFIC PURPOSE OF THE MONUMENT

PUNCH MARK TO BE SET IN THE FIXED MONUMENT DISK BY CONTRACTOR'S SURVEYOR

2 INCHES ROUND

NOT TO SCALE

NOTES:

THE MONUMENT MARKER SHALL BE 2 INCH DIAMETER AND MADE OF BRASS.

MARKER SHALL BE ENGRAVED WITH SURVEYOR'S NAME AND N.J. LICENSE NUMBER.

MARKER SHALL BE PUNCHED IN THE FIELD BY THE SURVEYOR.

IF THE POINT CANNOT BE SET, THE MONUMENT SHALL BE SET ON AN OFFSET AS COORDINATED WITH THE BERGEN COUNTY SURVEYOR.

THE MARKER SHALL BE ENGRAVED WITH DESCRIPTION OF ITS PURPOSE, SUCH AS, "PROP. CORNER", "COR. 10 FEET EASE" ETC.

THE SURVEYOR SHALL PROVIDE THE COUNTY WITH A SEALED PLAN WHICH INDICATES THE LOCATION OF EACH MONUMENT.

THE MONUMENT DISC SHALL BE SET FLUSH TO THE CONCRETE WHILE REMAINING VISIBLE AS PER N.J. MAP FILING LAW.

MONUMENT MARKER COORDINATE VALUES\*

| MONUMENT | NORTHING | EASTING |
|----------|----------|---------|
|          |          |         |
|          |          |         |
|          |          |         |

\*STATE PLANE COORDINATES IN NAD 1983 DATUM



Bergen County Department of Planning and Engineering

PERMANENT REFERENCE MARKERS

10/2024